



Instructions for Use

AC-1000 Series

Colposcope

Single-step colposcope AC-1110

Featuring LED Light Source:

- Lasts longer
- Cool to the touch
- Gives you move of a sure color balance



Now easier to move with our new Roller base. Plus, once in position, the platform remains stable.



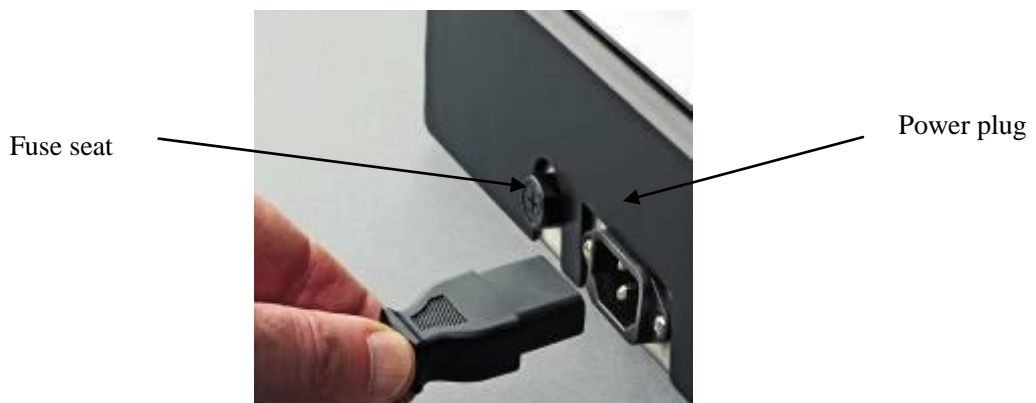
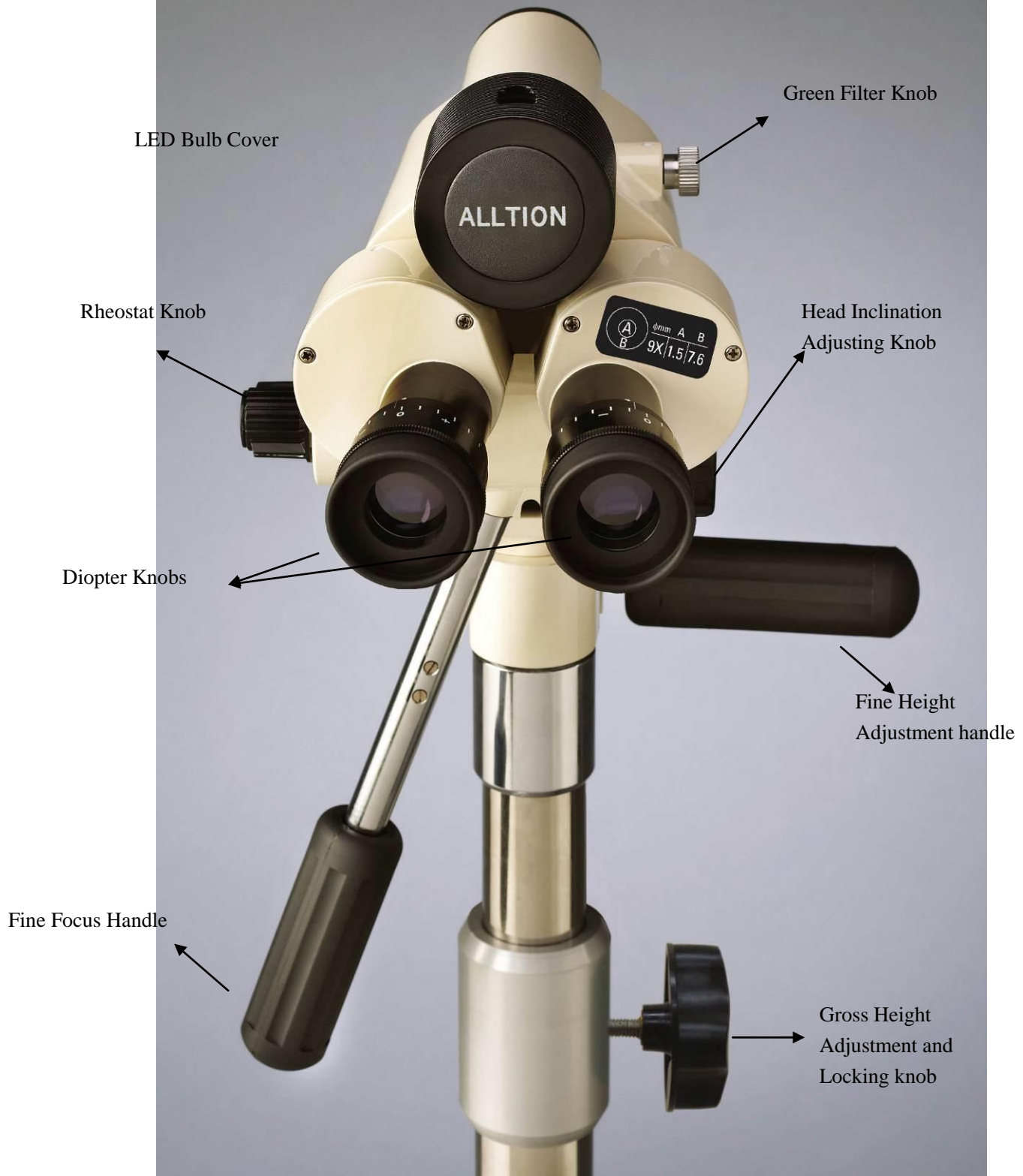

Three-step Colposcope AC-1310

Featuring LED Light Source:

- Lasts longer
- Cool to the touch
- Gives you move of a sure color balance



Now easier to move with our new Roller base. Plus, once in position, the platform remains stable.

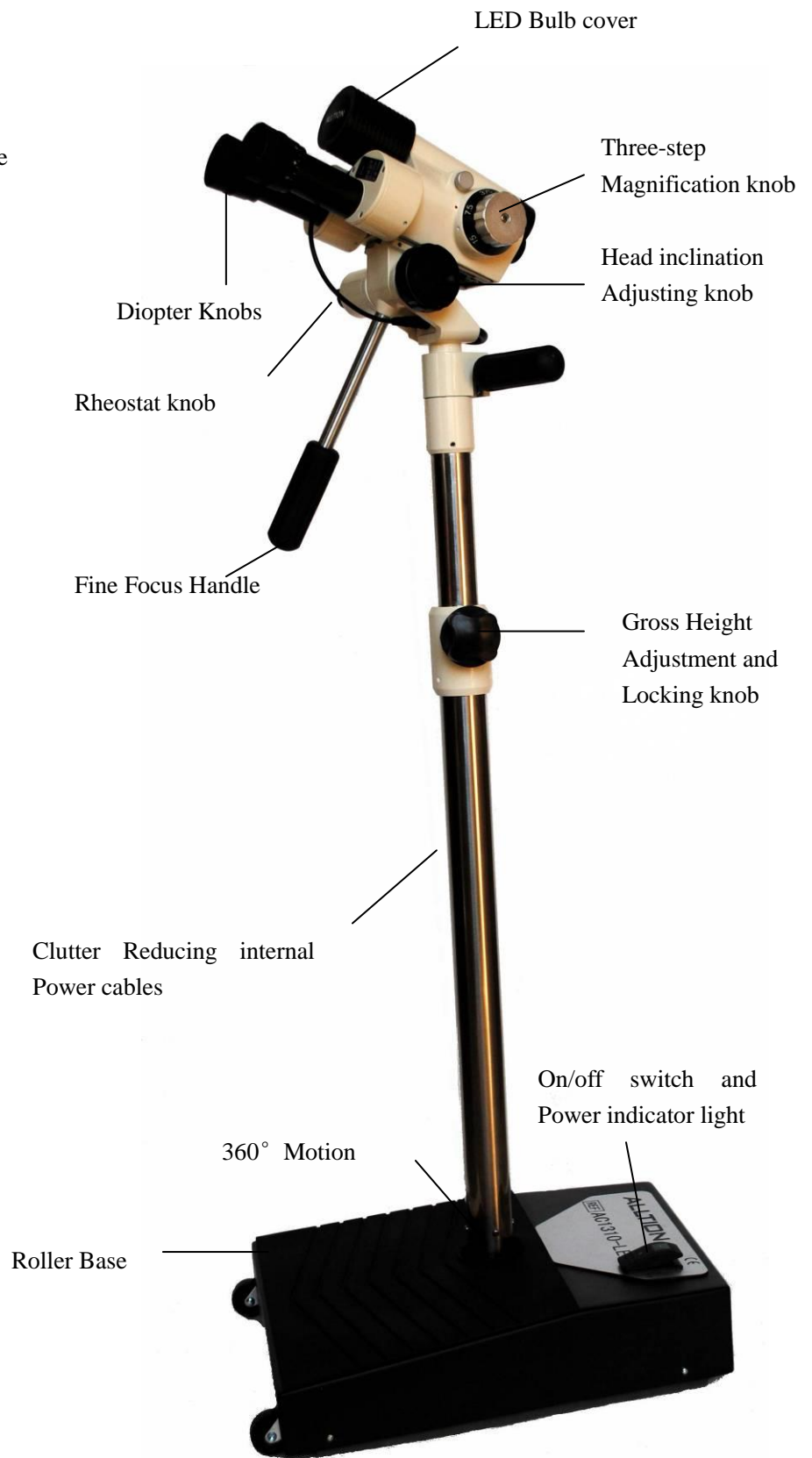

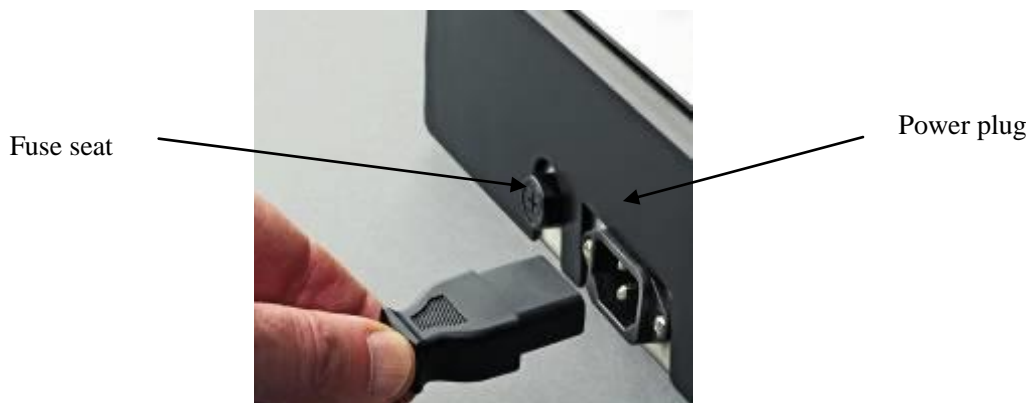
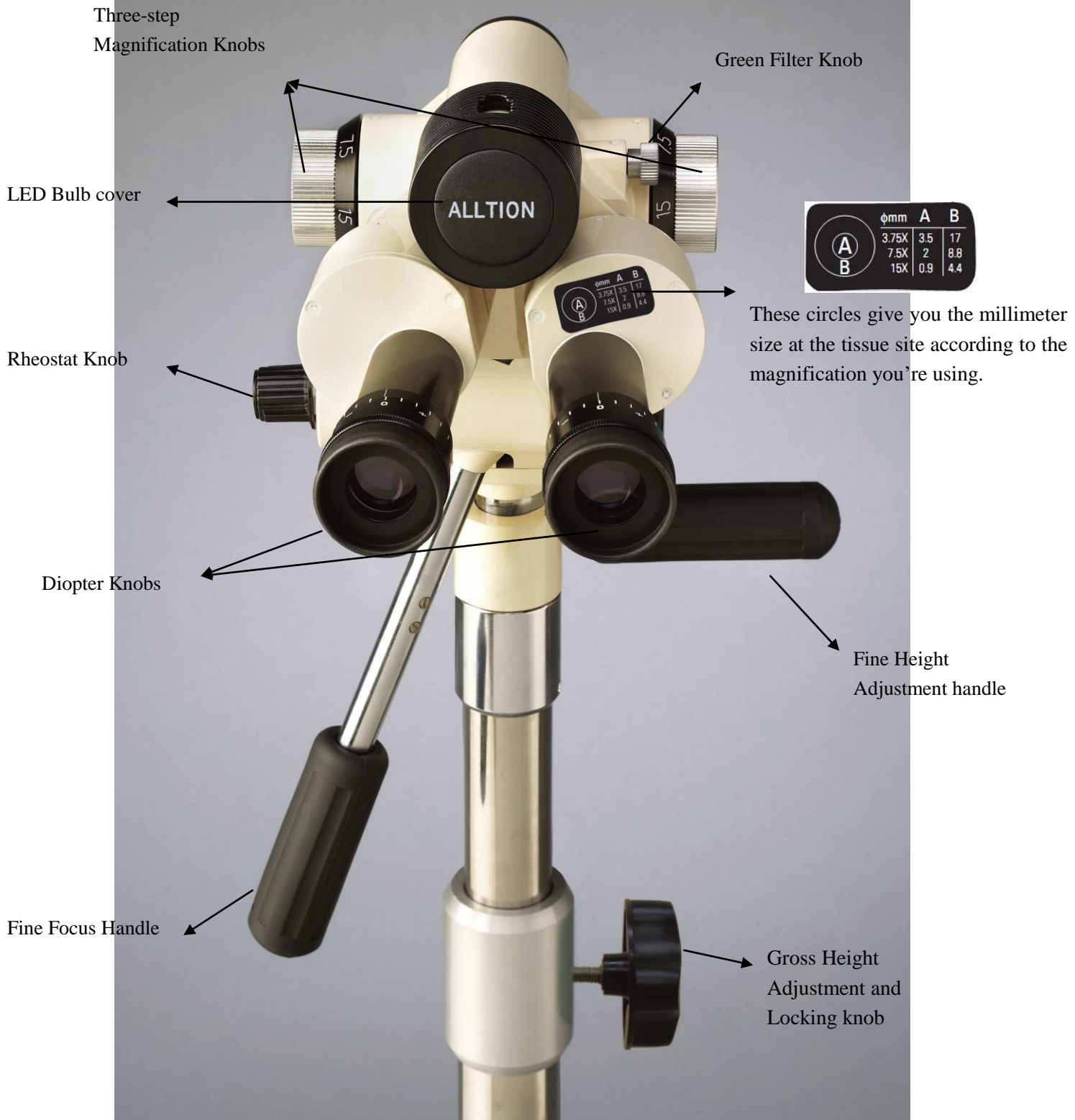

45° Three-step Colposcope AC-1320

Featuring LED Light Source:

- Lasts longer
- Cool to the touch
- Gives you move of a sure color balance



Now easier to move with our new Roller base.
Plus, once in position, the platform remains stable.

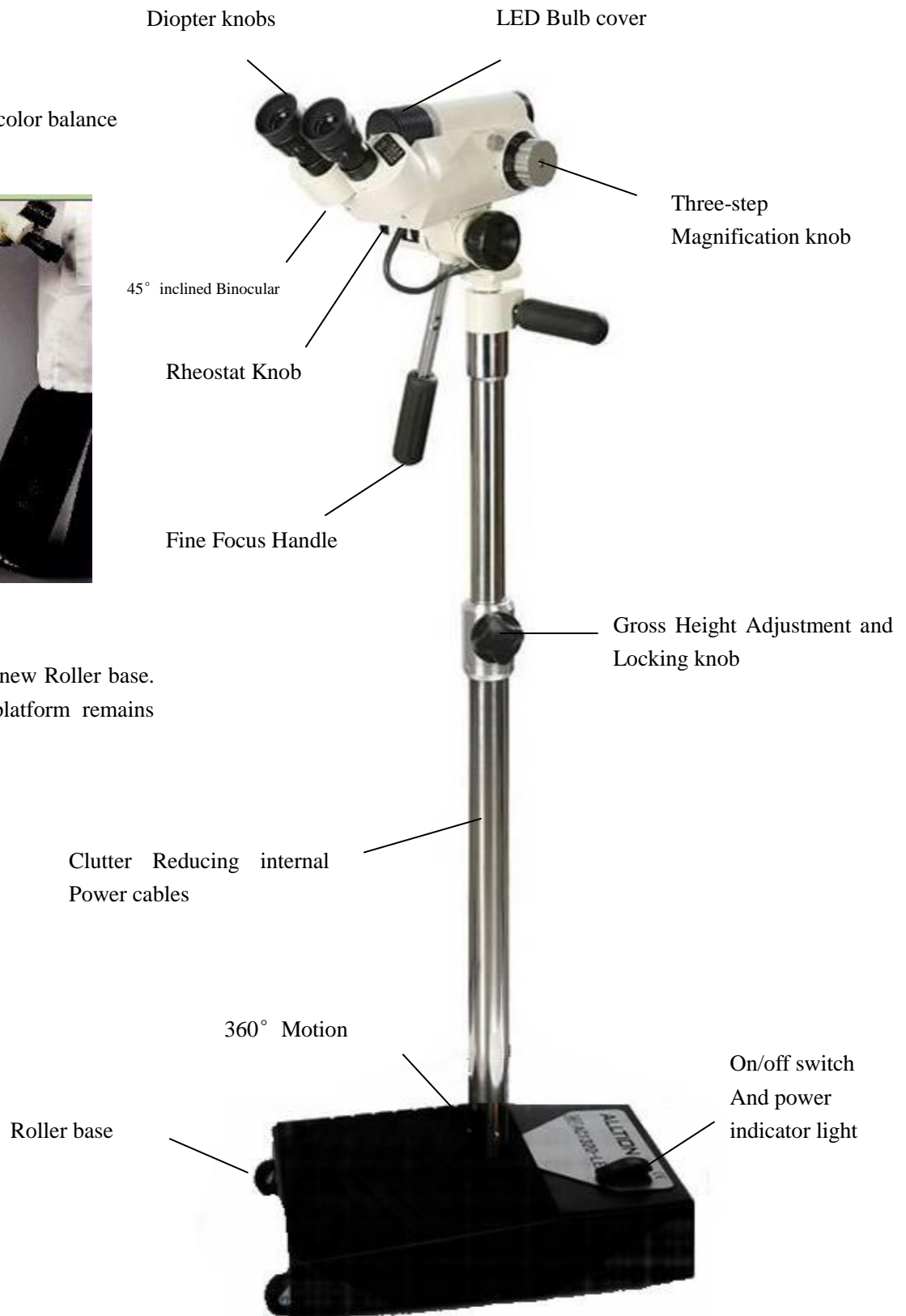

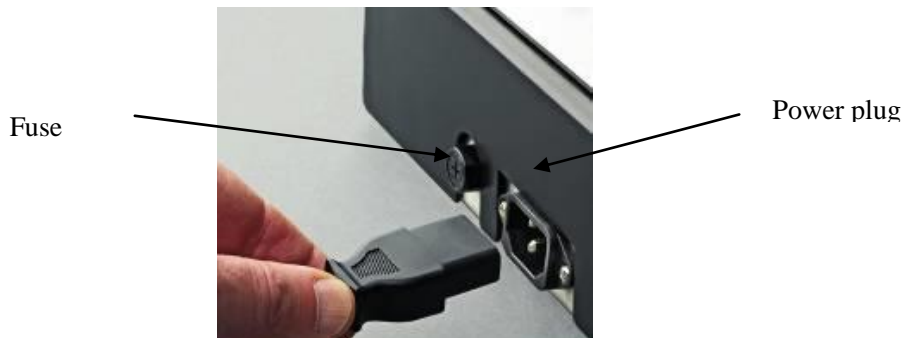
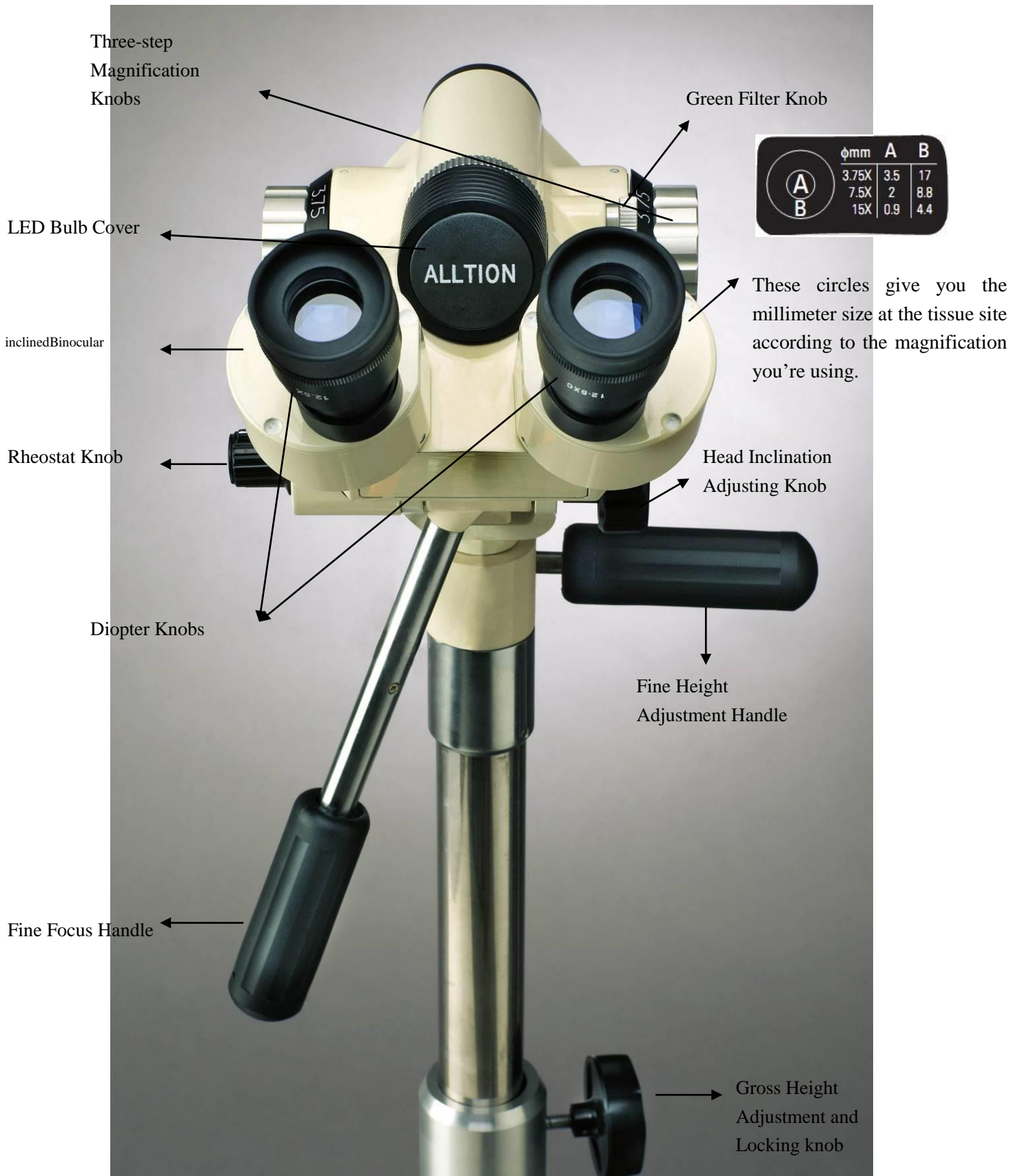

Indications for Use

The ALLTION brand Colposcope is a device designed to permit viewing of the tissues of the vagina and cervix by a telescopic system located outside the vagina. A Colposcope is used to diagnose and examine abnormalities of the vagina and cervix.

360° Motion



1. AC-1110 Features

- Hand polished optics for exceptional clarity
- Individual y adjustable binocular optics for true stereoscopic view
- Optical measuring circles for precise measurements
- Focal length: 316mm
Field of View: 22mm diameter
Depth of Field: 8mm
- Smooth adjustable controls for gross and fine focus
- Universal Teflon® ball joint never has to be tightened or adjusted and it gives you fluid 360° motion for gross focus
- A space saving small footprint: Length is 14", Width is 12"
- Clutter reducing internal power cable
- Working height: 838mm to 1194mm
- Clear, bright, long-lasting LED light source
- Light intensity: >25,000 LUX
- One piece shipping that puts you in operation with minutes of opening the box (no salesperson necessary)
- Overall magnification 9X

AC-1310 Features

- Hand polished optics for exceptional clarity
- Individual y adjustable binocular optics for true stereoscopic view
- Optical measuring circles for precise measurements
- Focal length: 300mm
Magnification: 3.75X, 7.5X, 15X,
Field of View: 9.5mm, 19mm, 38mm
Depth of Field: 5mm, 8mm, 34mm
- Smooth adjustable controls for gross and fine focus
- Universal Teflon® ball joint never has to be tightened or adjusted and it gives you fluid 360° motion for gross focus
- A space saving small footprint: Length is 14", Width is 12"
- Clutter reducing internal power cable
- Working height: 838mm to 1194mm
- Clear, bright, long-lasting LED light source
- Light intensity : >25,000 LUX
- One piece shipping that puts you in operation within minutes of opening the box (no salesperson necessary)
- Overall magnification 3.75X, 7.5X, 15X

AC-1320 Features

- Hand polished optics for exceptional clarity
- Individual y adjustable binocular optics for true stereoscopic view
- Optical measuring circles for precise measurements

- Optic angle is 45°
- Focal length: 300mm
Magnification: 3.75X, 7.5X, 15X
Field of View: 9.5mm, 19mm, 38mm
Depth of Field: 5mm, 8mm, 32mm
- Smooth adjustable controls for gross and fine focus
- Universal Teflon® ball joint never has to be tightened or adjusted and it gives you fluid 360° motion for gross focus
- A space saving small footprint: Length is 14", Width is 12"
- Clutter reducing internal power cable
- Working height: 838mm to 1194mm
- Clear, bright, long-lasting LED light source
- Light intensity >25,000 LUX
- One piece shipping that puts you in operation within minutes of opening the box (no representative necessary)
- Overall magnification 3.75X, 7.5X, 15X

2. Contents of Box

- 1 Colposcope
- 1 Power Cord
- 2 Fuses
- 1 Plastic Dust Cover
- 1 Instructions for Use
- 1 Phillips Screwdriver

3. Removing the Colposcope From the Box

The Colposcope comes with a one year warranty with free repairs (shipping not included). Please keep this box and the protective foam for at least a year; should you need to return it to ALLTION for any warranty repairs. Otherwise there will be a nominal fee for us to send you a new box.

- During the handling and unpacking, the box must be placed in the up position according to the arrows that are printed on the outer box.
- Remove top protective material.
- Grasp the Colposcope at the center post (A cutout in the foam for your hands is provided.) and lift the Colposcope straight out of the protective material. Note: When removing the instrument out of the protective foam, remove with care to prevent the instrument from being damaged.



4. Setting Up the Colposcope

- A. Remove the power cord from the shipping box.
- B. Insert the power cord into the plug located at the back end of the base.
- C. Insert the other end of the power cord into the wall socket. Note: It must be a three-hole wall socket, in order to ensure proper grounding of the instrument.
- D. Depress the power on/off button with your right foot, to turn on the power. The power indicator light will come on at that time.
- E. Important: Rotate the Rheostat Knob to turn on the Viewing Light.
- F. When the instrument is ready to be shut off, simply depress the power on/off button with your right foot. The power indicator light will go off



5. Precautions

- A. For storage, the instrument should be placed in a clean, dry environment with stable temperatures to extend the life of the components and ensure longevity of the instrument.
- B. Please cover the Colposcope with the plastic dust cover that is included with this instrument. This will keep the optics and components relatively dust free.
- C. When storing or carrying the instrument, instrument to the lowest position. This will help ensure that if it is inadvertently hit, it will resist tipping over.

5C



5B.

IPD



6. Adjustment of the Eyepieces

The interpupillary distance (IPD) is the distance in the spacing between a person's eyes.



6B.



To Adjust the IPD

- Turn on power by pressing the foot-switch on the base. On/off indication light will come on.
- Turn the black Rheostat Knob on the left to adjust the light intensity. Light will project from upper part of the Colposcope.
- Gently place your eyes against the black rubber eyepieces. Grasp the tan metal housing with both hands. Gently rotate the barrels together or apart. A singular circular image should be seen through both eyepieces. This adjustment is similar to adjusting the eyepieces of binoculars.

6C



Lenses Before Adjustment

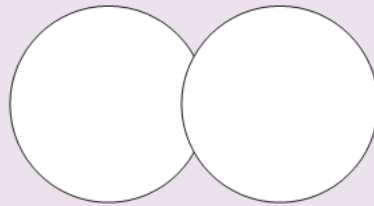

Lenses During Adjustment

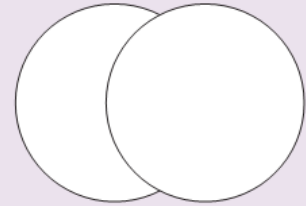

Lenses Adjusted

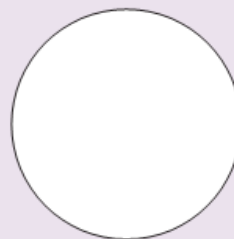



7. Adjustment of the Diopter Knobs

Focusing the Colposcope

- A. Set the Diopter Knobs at zero.
- B. Turn the Colposcope on, place your eyes against the eyepieces, and focus the Colposcope on a fixed object until that object appears clear and sharp.
- C. It is recommended to focus on letters such as a *book* or a *magazine*.
- D. Close your right eye. With your left hand, rotate the Diopter Knob until the object is clear and sharp for your left eye. Note: The Diopter allows you to adjust for plus and minus vision corrections.
- E. Then close your left eye. With your right hand, rotate the diopter knob until the object is clear and sharp for your right eye. Note: The Diopter allows you to adjust for plus and minus vision corrections.
- F. This adjustment of the diopters will put the in Colposcope focus. You will see two measuring circles through the lens. Since your Colposcope has three different magnifications, the measurement at the tissue site will vary according to the magnification you're using. The reference chart gives you the correct size per magnification change. Note: There is a chart on the right tan metal housing.
- G. It is important to keep a record of the adjustments on the Diopters for both your left and right eyes. Since most offices have multiple people using the Colposcope, the eyepieces will be different when someone else wants to use it. By remembering your diopter settings ,clarity can be achieved by simply moving the diopters to your setting when you are ready to use the Colposcope. This avoids you going through steps A–E each time.

A Note for Eyeglass Wearers:

For best results when wearing eyeglasses, fold down the Colposcope's rubber eye cups. Then place your eyeglasses against the folded down eye cups while using the Colposcope. When you are finished using the Colposcope, unfold the rubber eyepieces to maintain the correct memory in those rubber eyepieces.

Measurement At Tissue Site 3.75X

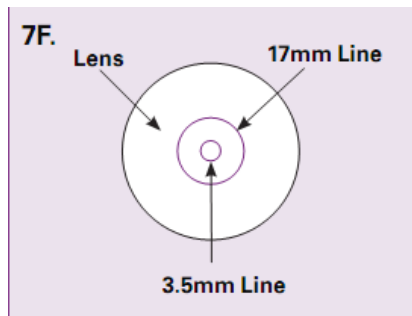

Measurement At Tissue Site 7.5X

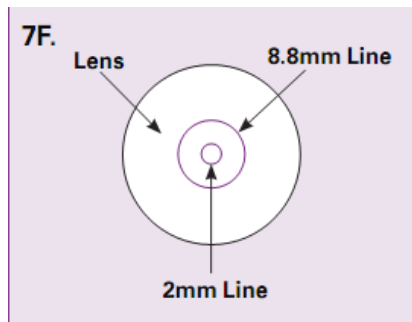

Measurement At Tissue Site 15X

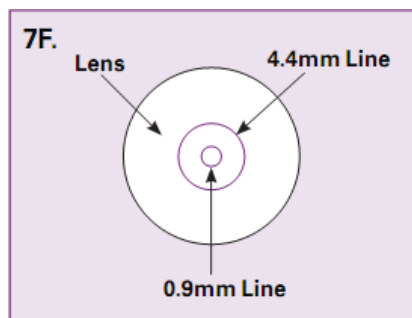

COLPOSCOPE DIOPTRER SETTINGS		
	LEFT EYE	RIGHT EYE
DOCTOR		
Dr. Brown	-2	+1
Dr. Smith	+2.5	+1
Dr. Tan	-3	

	φmm	A	B
3.75X	3.5	17	
7.5X	2	8.8	
15X	0.9	4.4	





8. Colposcope Instructions for Use

The following briefly describes using the Colposcope with a patient. It is recommended that you practice using the Colposcope to familiarize yourself with all of the features it has to offer.

A. With patient in lithotomy position, your Colposcope should be placed so that the head of the scope is 300mm from the area you wish to view, with the post to as near vertical as possible. Rotate the Gross Height Adjustment and Locking Knob to loosen it and move the inner post up or down. Tighten the knob to lock the inner post in place.

B. In a sitting position, place your feet on the rubber pad part of the base. Place your eyes against the eyepiece. Adjust for pupillary distance and make sure that you set your correct diopter reading. Place your right hand on the Fine Height Adjustment Handle and your left hand on the Fine Focus Handle. Note: Do not try to focus with Fine Focus Adjustment at this point.

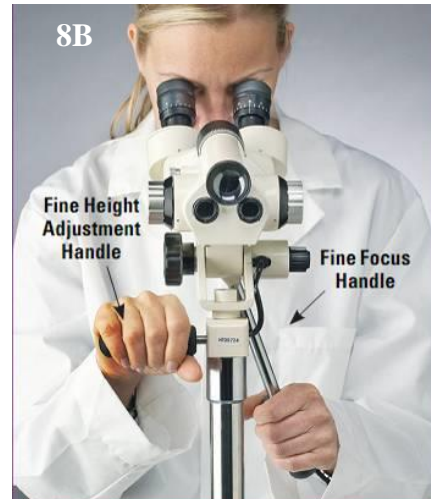

C. With your right hand on the Fine Height Adjustment Handle, slowly push or pull the Colposcope, until the field comes into view.

Angled optics for ease of use.

Move Head Up & Down

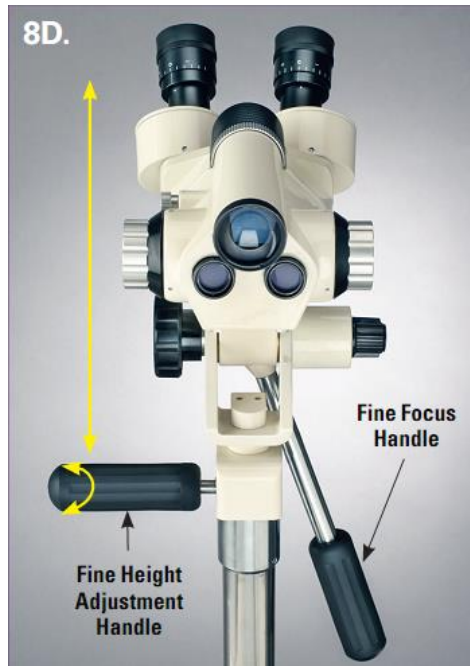

Twist the adjustment handle to move the head up or down.

If patient is not centered, you can move the Colposcope head in multiple directions to change your field of vision. See photos D–H.

Move Head Left



Push the Fine Height Adjustment Handle forward and to the left (counterclockwise).

Move Head right



Pull the Fine Height Adjustment Handle backward and to the right (clockwise).

Angle Head Up

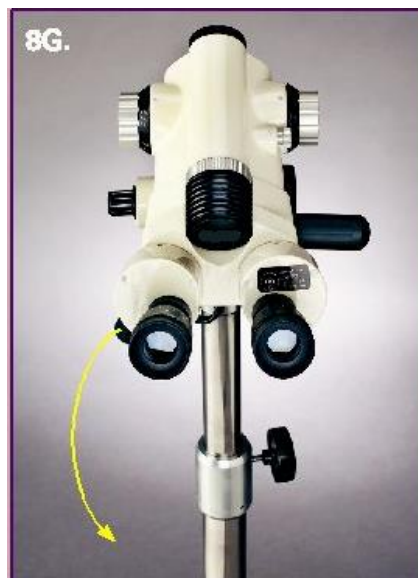

Push the Fine Focus Handle down and forward.

Angle Head Down



Pull the Fine Focus Handle up and backward.

I. Adjust the Fine Focus Controls to provide clear, magnified views of the area to be examined. Rotate your left hand on the Fine Focus Handle which will finely move the optics towards or away from the object that you wish to view. Also, rotate your right hand which is on the Fine Height Adjustment Handle up or down to raise or lower the optics. Adjust light intensity rheostat as needed by turning the black Rheostat Knob. Turn the silver Green Filter Knob for optimum assessment of affected area.



Note: Both the black Rheostat Knob and the silver Green Filter Knob are conveniently located on the Colposcope head, thus allowing the user complete control without looking up from the eyepieces.

J. The Colposcope head may be tightened or loosened your preference by turning the Head Inclusion Adjusting Knob.



according to Knob.



9. Selecting Your Preferred Level of Magnification

The AC-1310 & AC-1320 offer you the advantage of increasing or decreasing magnification during a colposcopic examination.

A. When viewing the cervix, reach up and rotate the Three-Step Magnification Knob.

B. Rotate it to your desired magnification (3.75, 7.5, or 15). When moving from one magnification to another, slight adjustments in the fine focusing mechanism might be necessary.

C. Turn the Fine Focus Handle.





10. Moving the Colposcope

- A. Rotate the Gross Height Adjustment and Locking Knob to move the post to a comfortable position.
- B. Tighten the Gross Height Adjustment and Locking Knob.
- C. Place your foot between the wheels at the front end of the base.
- D. With your hand on the Fine Height Adjustment Handle, pull forward and roll across the floor.

11. Fuse Replacement

- Unscrew the Fuse Seat located at the back end of the base using the Phillips screwdriver that is included with the Colposcope. Remove the broken fuse (dispose of correctly).
- Replace with the fuse that is also included with the Colposcope. Two fuses have been included for your convenience.
- Screw the Fuse Seat into the proper position, using a Phillips screwdriver.

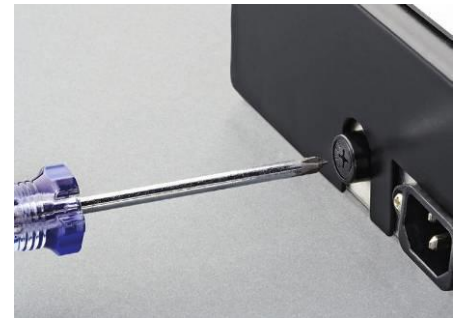

12. Troubleshooting

Viewing Light Will Not Come On

On-Off Light Indicator Burning

- Check power plug to ensure that it is secure.
- Rotate the black Rheostat Knob.
- Call local dealer for assistance

On-Off Light Indicator Not Burning

- Light indicator bulb may be burned out.
- Push On/Off switch.
- Check cord to see if plug is in at both the Colposcope and wall socket .
- Check fuse. The fuse is located on the front edge of the tilt stand base.
- Check wall plug with another electrical instrument
- Call local dealer for assistance

Colposcope Head Keeps Turning

- Tighten Gross Height Adjustment and Locking Knob.

13. Information about disinfection for Alltion LED Colposcope

You can wipe the colposcope with alcohol on a clean cloth, and you can use the disposable alcohol pads, usually used to clean skin. Care must be taken not to put the alcohol on any lenses, whether that be the lenses the doctor looks through or the lenses towards the patient.

14. Disposal

Disposal: Information according to Art. 13 of Legislative Decree 14 March 2014, n. 49 "Implementation of Directive 2012/19/ EU on the reduction of hazardous substances in electrical and electronic equipment, as well as waste disposal.



The crossed-out wheeled bin symbol on the appliance or its packaging indicates that, at the end of its useful life, the product must be collected separately from other waste.

Separate waste collection of this equipment, at the end of its useful life, is organized and managed by the manufacturer. The user who wants to dispose of the present equipment will then have to contact the manufacturer and follow the system that this has implemented to allow the separate collection of the equipment at the end of its life.

The appropriate separate waste collection of the equipment avoids possible negative effects on the environment and on health and allows the re-use and/or recycling of the materials of which it is made the equipment.

The improper disposal of the product by the holder involves the application of the administrative penalties provided for by current legislation.

14. GIMA Warranty Conditions

This product meets high qualitative standards both as regards the material and the production. The warranty is valid for 12 months from the date of supply of GIMA.

During the period of validity of the warranty, GIMA will repair and/or replace free of charge all the defected parts due to production reasons. Labor costs and personnel traveling expenses and packaging not included.

All components subject to wear are not included in the warranty.









The repair or replacement performed during the warranty period shall not extend the warranty.

The warranty is void in the following cases: repairs performed by unauthorized personnel or with non-original spare parts, defects caused by negligence or incorrect use.

GIMA cannot be held responsible for malfunctioning on electronic devices or software due to outside agents such as: voltage changes, electro-magnetic fields, radio interferences, etc.

The warranty is void if the above regulations are not observed and if the serial code (if available) has been removed, cancelled or changed.

The defected products must be returned only to the dealer the product was purchased from. Products sent to GIMA will be rejected.

Symbol	Description
	The product complies with European Directive 93/42/EEC and further amendments (enforced in Italy by Leg. Decree No. 46/97 and further amendments)
	Authorized representative in the European community
	Manufacturer
	Products should not be disposed of with household waste
	Keep away from sunlight
	Keep dry
	Please read the warnings carefully
	Please read the instructions carefully
	Date of manufacture

Distributed by:

Gima S.p.A. - Via Marconi, 1
20060 - Gessate (MI) - Italy



Alltion (Wuzhou) Co., Ltd.
Alltion Building, NO. 10, 3rd Road, Wuzhou Industrial Park,
Wuzhou, Guangxi, China
Made in China (P.R.C.)



Obelis S.A.
Bd.Général Wahis 53 1030 Brussels-Belgium